



APPROVED

PLAN No. CB/403/19
MB/CB/16/2020
Date: 30.06.2020

Commissioner
Durgapur Municipal Corporation

Mohan Lal Majee,
Planner in-Charge, Building Plan,
Durgapur Municipal Corporation

PERMISSION GRANTED
FOR ACT AND BUILDING
PLAN REGULATIONS, 2006

Structural Safety Should be
Ensured by the Party.

BUILDING PLAN APPROVED
ON THE BASIS OF THE INDE-
MUNITY BOND. LAND MUTATION
& CONVERSION IS THE RESPO-
NSIBILITY OF THE OWNER

| DOOR - WINDOW SCHEDULE | | | | | | |
|------------------------|----------|--------|-----|--------------|--------|--------|
| DOORS | DOORS | | | WINDOWS | | |
| | WIDTH | HEIGHT | MKD | WIDTH | HEIGHT | LINTEL |
| D0 | 1200 | 2150 | W0 | 1500 | 1500 | 2150 |
| D1 | 1100 | 2150 | W1 | 1200 | 1700 | 450 |
| D2 | 900 | 2150 | W2 | 600 | 1700 | 450 |
| D3 | 750 | 2150 | W3 | 900 | 1050 | 1100 |
| D4 | 1000 | 2150 | W4 | 600 | 900 | 1250 |
| SD1 | 2100 | 2150 | SW | 1200 | 1700 | 450 |
| FCD | 1200 | 2150 | FG | VARIABLE | 2000 | 150 |
| RS | VARIABLE | 2150 | WF | WALL TO WALL | WINDOW | 2150 |

- NOTES:-
1. ALL DIMENSIONS ARE IN MM. UNLESS OTHERWISE MENTIONED.
 2. ALL EXTERNAL WALLS ARE 200 THK & INTERNAL WALLS ARE 125 THK.
 3. IF NOT STATED IN 1:4 CEMENT SAND MORTAR.
 4. ALL HORIZONTAL PROJECTIONS ARE 125 THK & 500 MM PROJECTED.
 5. GRADE OF CONCRETE & GRADE OF STEEL USED ARE M30 & M50 & Fe500 RESPECTIVELY.
 6. R.C.C. FRAMED STRUCTURE.
 7. ANY DISCREPANCY IN SCALE, THE WRITTEN DIMENSION SHALL GOVERN.
 8. FOR SPECIFICATION OF MATERIALS & WORKMANSHIP N.B.C. 2016 TO BE FOLLOWED.
 9. OPEN TERRACE WITH LIME TERRACING OF RATIO 2:2:7.
 10. DAMP PROOF COURSE TO BE PROVIDED WITH P.C.C. (1:2:4).

PROJECT :

PROPOSED ARCHITECTURAL PLAN FOR
COMMERCIAL CUM RESIDENTIAL
(APARTMENT) COMPLEX CONSISTING OF
SINGLE TOWER HAVING 2 NOS. WING (A&B)
OF G+10 STORIED BUILDING (BY THE OF "
SHRI KRISHNA KUNJ RESIDENCY) OF SRI
DILIP KUMAR BARNWAL & OTHER'S OVER
R.S. PLOT NO. - 217, 225, L.R. PLOT NO. -
597,768 L.R. KHATIAN NO. - 5984, 5985, 5986
,5990, 5991, 5992, 5993, 6006, 6008, 6009
,6010, 6105, 6106, AT MOUZA- FULJHORE,
J.L. NO.-107 (OLD 82), P.S. - N.T.P.S.,
A.D.S.R. DURGAPUR, DIST - PASCHIM
BARDHAMAN, PIN. NO-713206

SIGNATURE OF OWNER

Certified that I have gone through the building rules of Durgapur municipal (building) Corporation 2006 and its amendment & also undertake to abide by those rules during & after the construction of the building.

- | | |
|------------------------|---------------------|
| 1. Dilip Kumar Barnwal | 10. Kasi Akhul Ha |
| 2. Pranab D. Ray | |
| 3. Binay Kr. Bhadani | |
| 4. Jagannath | 12. Sanghamitra Ray |
| 5. Ritika Rani Gupta | 13. Dilip Ch. Das |
| 6. Dhruv Mondal | |
| 7. Anshu Parame | |
| 8. Bhakti Bhumi Mondal | |
| 9. Rita Devi Gupta | |

SIGNATURE OF ARCHITECT

I/We do hereby certify that plans, elevations and sections and other structural details of the above said building have been prepared in conformity with all relevant provisions under Durgapur municipal (building) Corporation 2006. This also to certify that relevant "No Objection" certificates from the respective Authorities such as Fire and Emergency Services Department, Airport Authority, Pollution Control Board, Telecommunication Department etc as applicable in this regard are also enclosed with the application for seeking approval of the plan to construction /reconstruct/ addition to alteration of the building on the said Plot.

KAMAL KUMAR PERIWAL
CA-95-18679

SIGNATURE OF GEOTECHNICAL ENGINEER

DR. SUJIT KUMAR BOSE
Ph.D., M.C.E. (Soil), B.C.E. (Hons)
MIGS, MIB
Empanelled Geotechnical
Engineer (I) under KM
Licence No: GT-12

SIGNATURE OF ARCHITECT / ENGINEER

CHANDI PROSAD KHANRA
SANJIB GUHA
STRUCTURAL CONSULTANT
BSC, BDE, FIE, Chartered Engineer
Structural Reviewer (K.M.C)
Empanelled No. - ESR (I) 88/16
Structural Reviewer (NKDA)
Empanelled No. - ST/EN/ND/1500003
ESE-I/2

TITLE :

| | |
|-----------|--------------------------------|
| DRG. NO. | MA/DURGAPUR/SUBMISSION/ARCH-01 |
| REV. DATE | |
| SCALE | 1:100 |
| DATE | 06.07.2019 |
| DRWG. BY | ADRIKA |
| CHECKED | BIBER |

ARCHITECT :

MAHESHWARI & ASSOCIATES
37A, BAKER ROAD, 2ND. FLOOR,
Tel : 65334966,
www.architectmaheshwari.com KOLKATA - 27

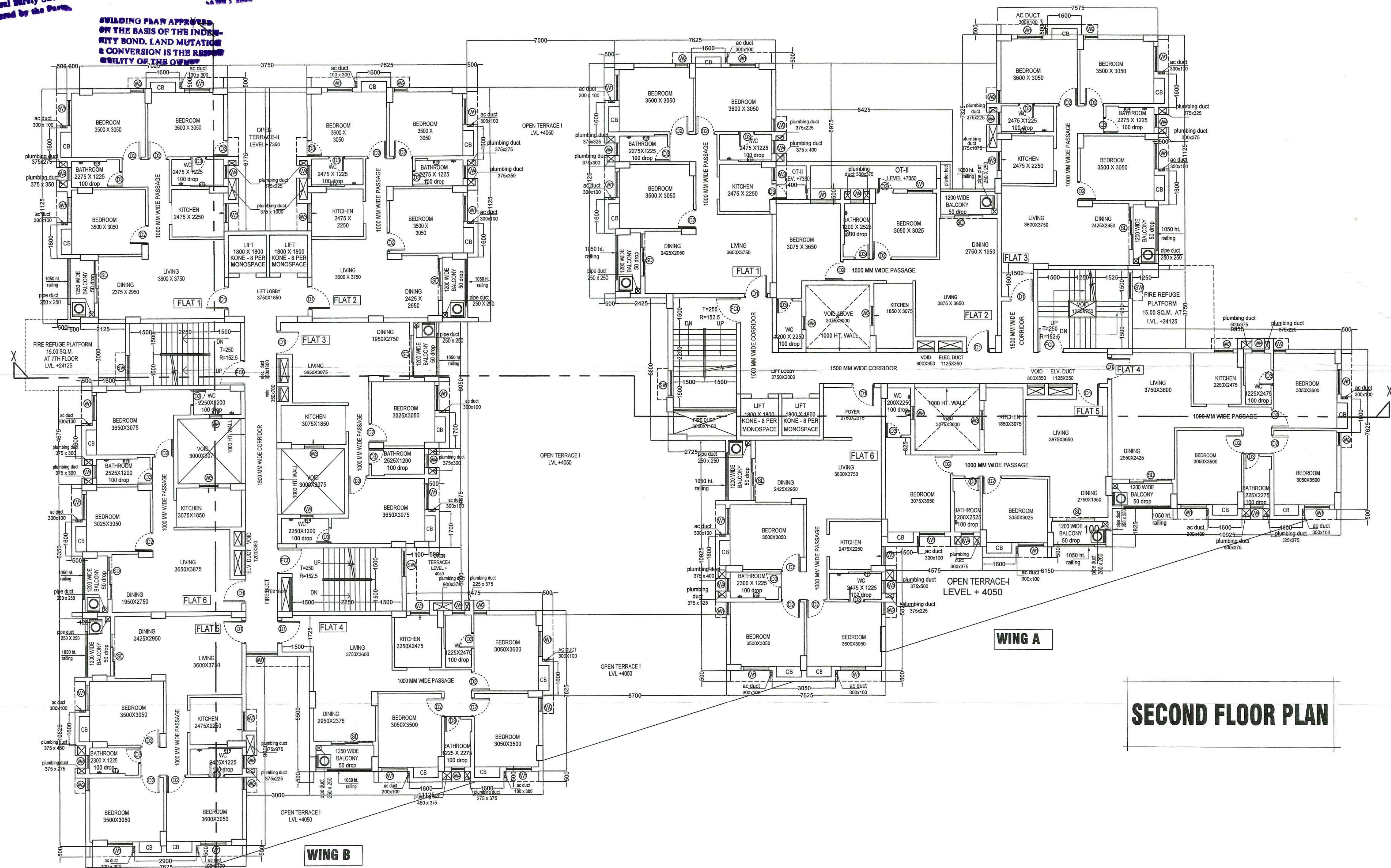

SECOND FLOOR PLAN

4